

STOP! READ FIRST!!

Fixture must have silicone plugs installed in proper orientation

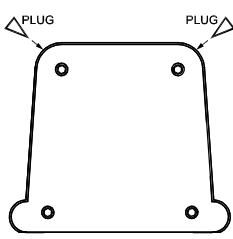

Downlight

Luminaires **MUST** have silicone plugs installed in proper orientation.

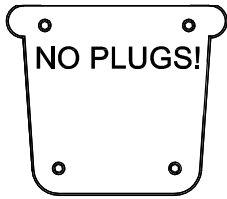

Uplight

Luminaires **DO NOT USE** silicone plugs!

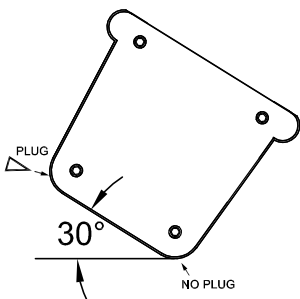

Angled Uplight

Luminaires over 30 Degrees **MUST HAVE** upper hole **PLUGGED!** Leave lower hole un-plugged.

STOP! READ FIRST!!