

# Minatura 1300s

## Signlighter

120VAC

ORGATECH

Project
Date



LS 4w/ft	Delivered Output	Watts
1ft	480lm	4w
2ft	960lm	8w
3ft	1440lm	12w
4ft	1920lm	16w

LH 8w/ft	Delivered Output	Watts
1ft	960lm	8w
2ft	1920lm	16w
3ft	2880lm	24w
4ft	3840lm	32w

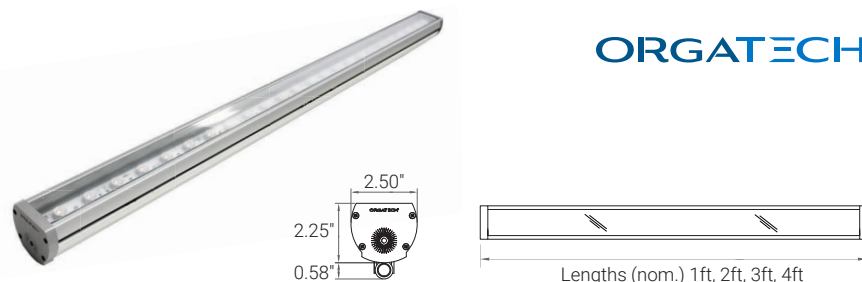

### DESCRIPTION

120V LED arrays with 120° distribution for general signlighting wallwashing creates a powerful energy efficient and economical linear floodlight. Simple specification & snap-together power and control connectors enable time saving installation. Fixtures run cooler than competing products and ensure long LED life in extreme climates such as desert locations. Perfect for signs and wallwashing applications, with unparalleled uniformity.

### FEATURES

Construction	Anodized Aluminum w/ Diecast Endcaps. Polycarbonate lenses.
Length (nom.)	1ft, 2ft, 3ft, 4ft
Weight	1lb/ft
White CCT	2700K, 3000K, 3500K, 4000K, 5000K
Dimming	Non-dimming, Forward Phase (TRIAC), Reverse Phase (ELV)
Optics	120°
Mounting	Swivel Mount, Extended Arm, Extended Hub Bracket, L Bracket, Sliding Bracket & Permapost
Finish	Anodized Silver, Powder Coat Bronze, Black, White & Custom

### PERFORMANCE

Electrical	120VAC
LED Wattage	LS 4W/ft (480lm/ft) - Standard / LH 8W/ft (960lm/ft)- High
Environment	Wet Location - IP67. Operating Temperature - 22°F to 122°F
Warranty	5 yr/ 50,000 hour limited warranty
CRI	90+

**Certifications** UL Listed, ROHS, 3G Rated , UL Tested in accordance to ANSI C136.31-2018, BAA and BABA Options Available

**ORDERING GUIDE** Make selections by filling out the top row or highlighting options.

1300s										
SERIES	LENGTH	OUTPUT	CCT	VOLTAGE	CONTROL	OPTICS	MOUNTING	FINISH	ACCESSORY	CERTIFICATIONS
1300s	1 1'nom 2 2'nom 3 3'nom 4 4'nom	LS STANDARD LH HIGH	27 2700K 30 3000K 35 3500K 40 4000K 50 5000K	AC120 120V	ND NON DIMMING TRI FORWARD PHASE ELV REVERSE PHASE	120 120°	SW SWIVEL MOUNT Ax EXTENDED ARM (x=length: 4 - 36in) HBxx EXTENDED HUB BRACKET(x=length) LB L-BRACKET SB SLIDING BRACKET	SO SILVER BZ BRONZE BL BLACK WH WHITE CU CUSTOM	G GLARE SHIELD P PERMAPOST M MARINE GRADE FINISH 2 NATATORIUM WAF* WILDLIFE AMBER FILTER SF** SURGE PROTECTOR & INLINE FUSE N NONE	BAA BAA BABA BABA N NONE

Specifications sheets are subject to change without notification. \*RECOMMENDED FOR USE WITH 4000K, 3500K, 3000K, 2700K ONLY \*\*SF OPTION LINE VOLTAGE REQUIREMENT MUST NOT EXCEED 120VAC

PHOTOMETRICS AND OPTICS

Aiming fixtures with the lens options shown enable perfect asymmetric performances to meet the needs of any wallwashing project. Combining easy specification with easy aiming for long throw with even, shadowless distribution.

PHOTOMETRIC DATA - LS 4W/ft (based off 4ft fixture)

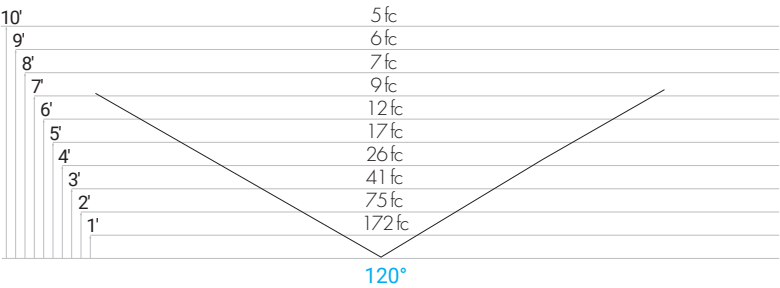

PHOTOMETRIC DATA - LH 8W/ft (based off 4ft fixture)



OPTICS

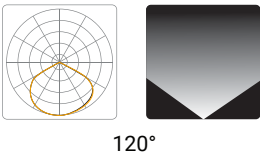

FIXTURE SIZES

1ft nom.

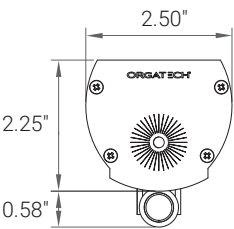
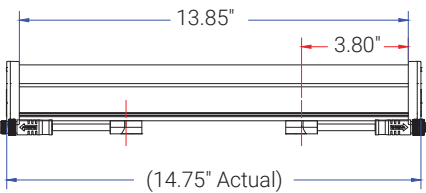

2ft nom.

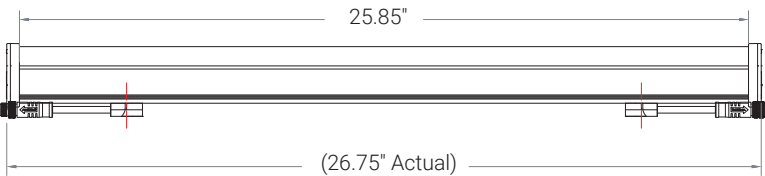

3ft nom.

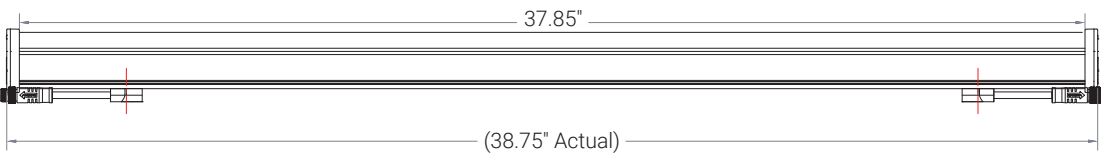

4ft nom.

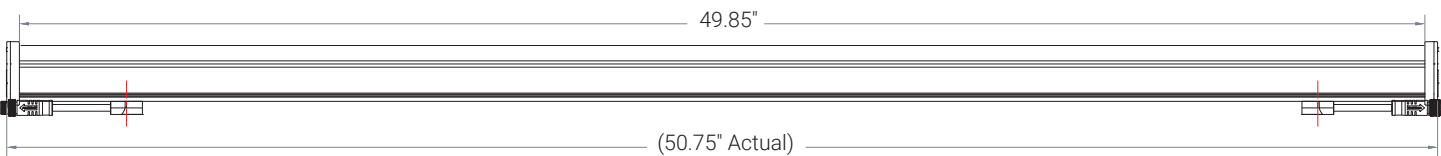

## MOUNTING INSTALLATION

### SWIVEL MOUNT

A heavy duty adjustable swivel mount with mounting plate. 1/2" nipple (can be specified) mounts directly to weatherproof canopies.

\*(2) Swivel Mounts needed per fixture for 3G rating to apply.

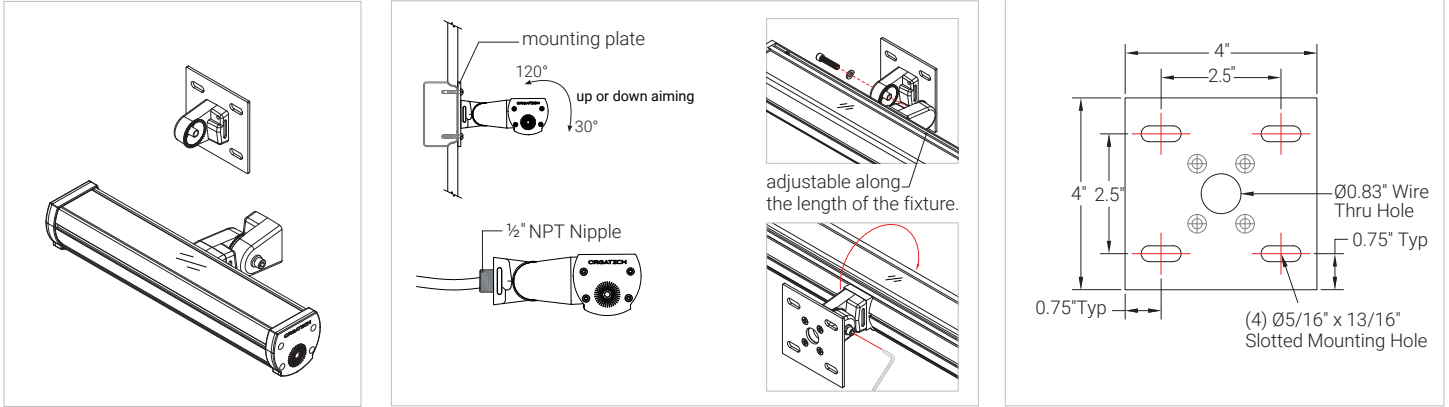

### EXTENDED ARM

With swivel mount, extended arm is available in 4"-36" lengths. Power cords can be routed through arms, exiting close to the wall to connect to an adjacent j-box or other power outlet, providing a tidy installation.

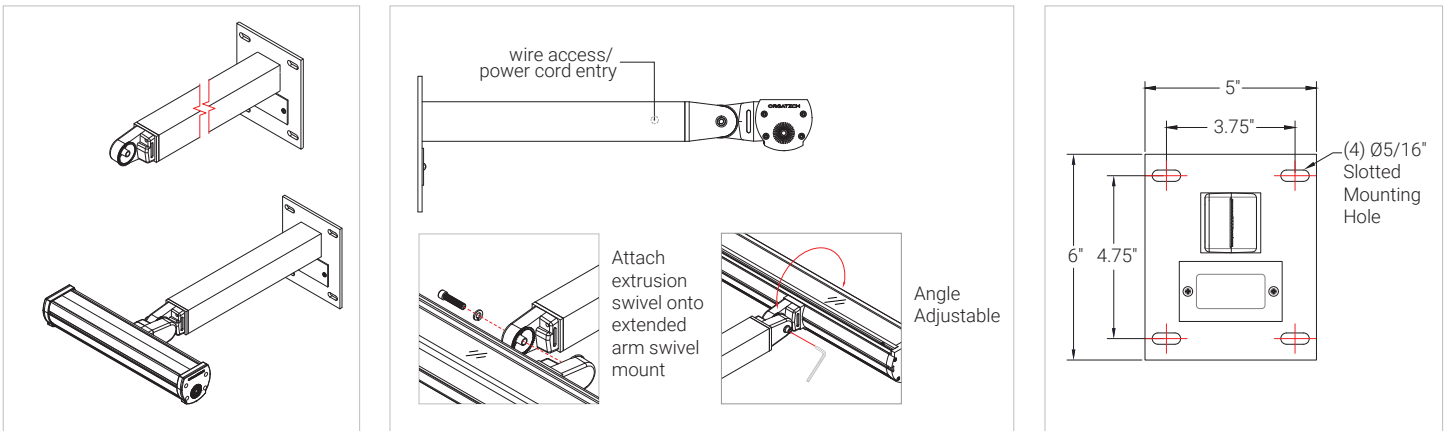

### EXTENDED HUB BRACKET

Available in 4"-36" lengths.

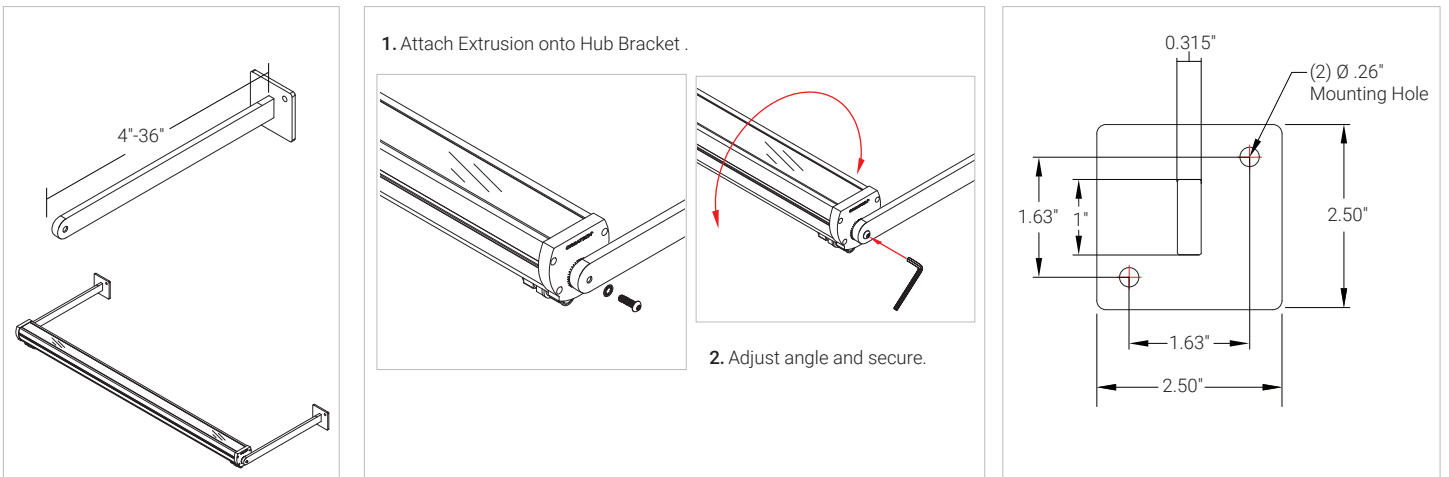

Specifications sheets are subject to change without notification.

## MOUNTING INSTALLATION

### L-BRACKET

Surface mounts in position with No. 10 screws (not supplied). All fixtures require two brackets.

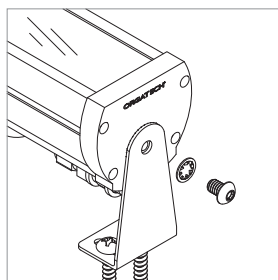
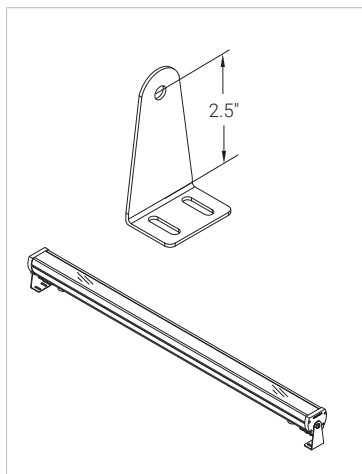

1. Insert fixture(s) in between the secured L Bracket(s).
2. Insert washers and screws in the correct order.

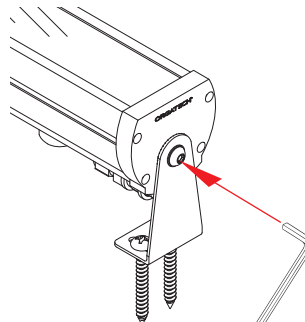

3. Rotate fixture and secure.

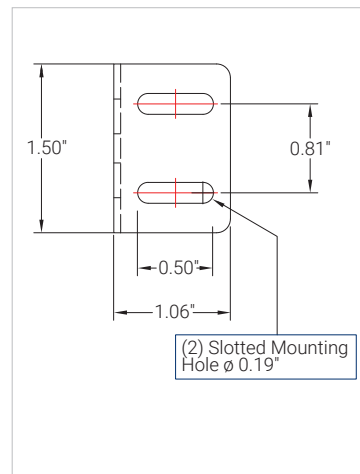

### SLIDING BRACKET

Surface Mount Aluminum Sliding bracket. Designed to allow the fixture to rotate and aim 180 degrees and mount flat to any surface. Two Brackets required for fixtures longer than 2 ft.

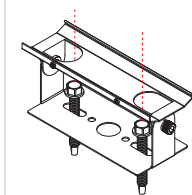

1. Mount Sliding Bracket to flat surface using 10-32 screws (per installer).

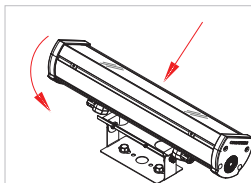

2. Mount fixture to Sliding Bracket.
  - Tilt fixture to fit the inside of the Sliding Bracket.
  - Then tilt the other side of the fixture down.

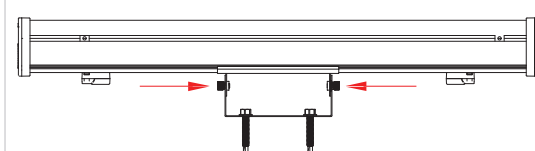

3. Secure fixture by tightening screws.
  - Sliding Bracket can slide along the housing to desired location.
  - Secure fixture by tightening M4 screws (provided) into the groove of the fixture.

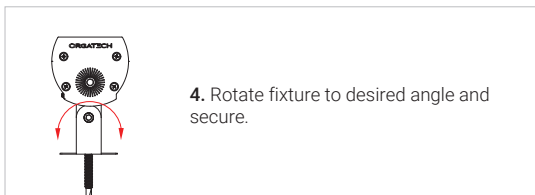

4. Rotate fixture to desired angle and secure.

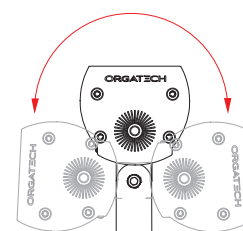
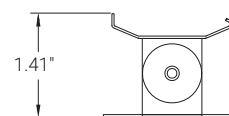

ACCESSORIES

GLARE SHIELD

Minimizes a direct glare, while maintaining the LED output.

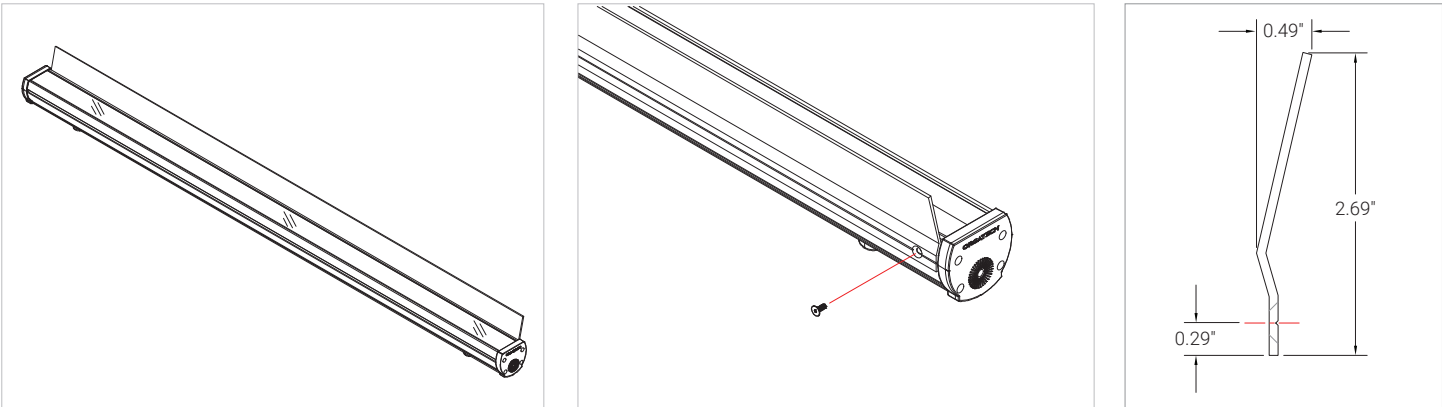

PERMAPOST

Provides easy at-grade installation. Includes swivel mount with 1/2" nipple. Fixture must be mounted at least 4" above ground level to avoid water accumulation.

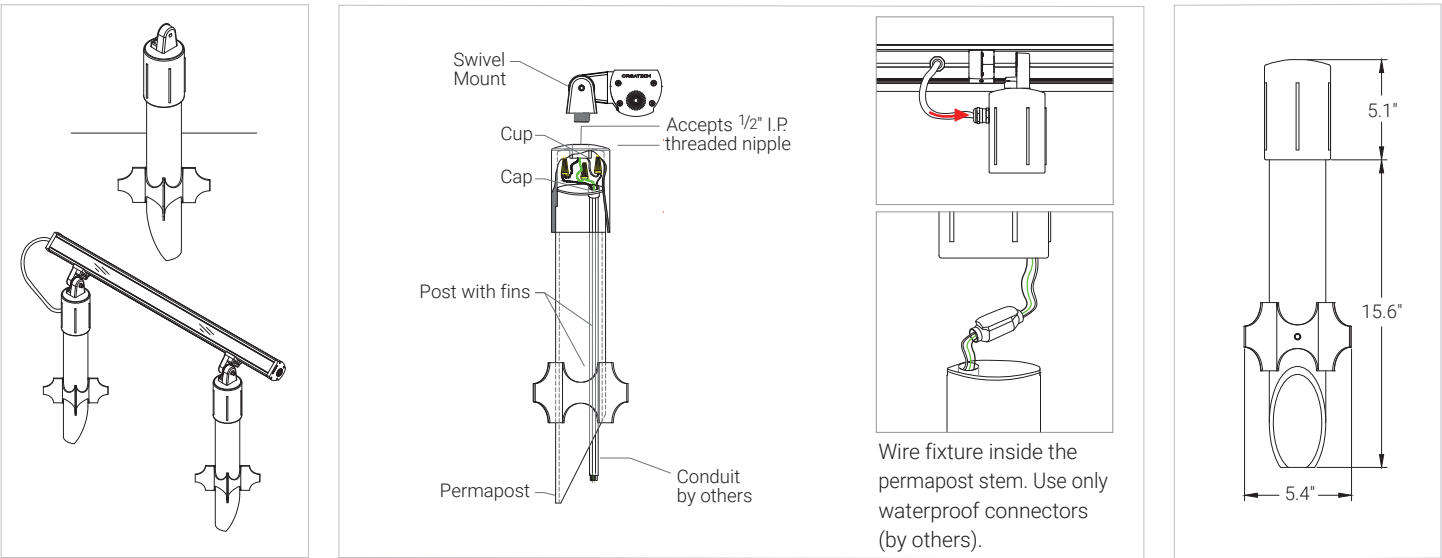

STARTER CABLE

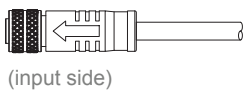

JUMPER CABLE

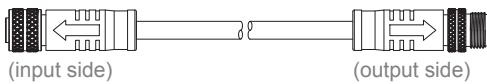

END CAP (output side)



PART #	DESCRIPTION
M12-SC-4FT	48" Starter Cable
PART #	DESCRIPTION
M12-JC-1FT	12" Jumper Cable
M12-JC-2FT	24" Jumper Cable
M12-JC-3FT	36" Jumper Cable
M12-JC-4FT	48" Jumper Cable
PART #	DESCRIPTION
M12-FC-ENDCAP	End Cap (output side)

\*longer cable lengths available per request.

Specifications sheets are subject to change without notification.

ELECTRICAL DETAILS

Non-Dimming | 3 Wire

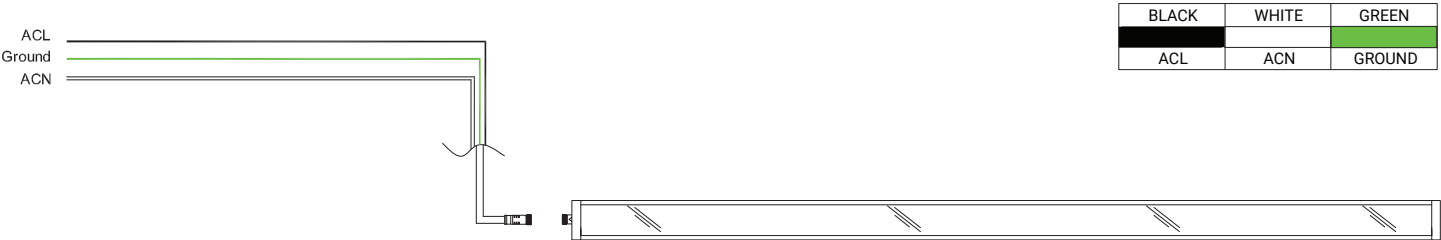

TRIAC | Forward Phase | 3 Wire

Based on Lutron DIVA C•L DVCL-253P 250W

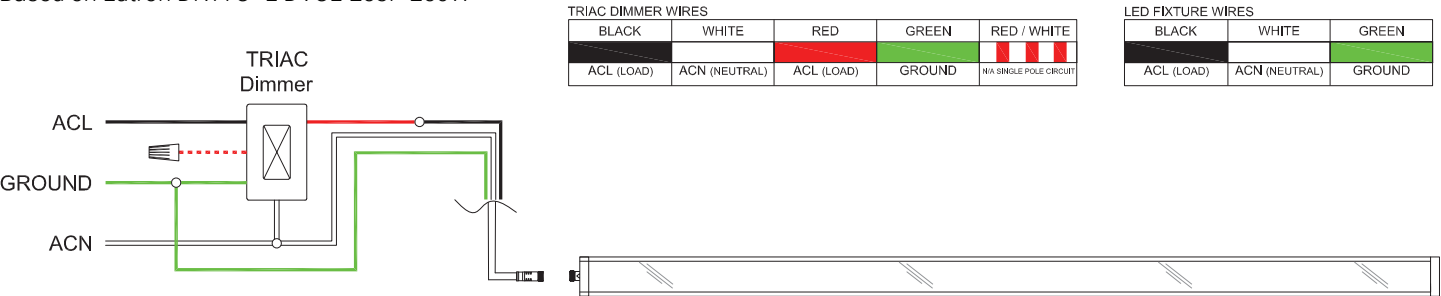

ELV | Reverse Phase | 3 Wire

Based on Lutron DIVA DVRP-253P 250W & Lutron DIVA DVELV-303P-WH 300W

